



Explosion Proof LED Lighting



EXPLOSION PROOF

PN: EX6310



High Quality LED Lighting!



CERTIFICATION & APPROVALS

- IP65
- GB CODE: Ex IB II CT4
- GB CERTIFICATE CNEX09.0865
- STANDARD: GB3836.1-2000 GB3836.4-2000

FEATURES

- EXPLOSION PROOF DESIGN
- CREE LED LIGHT SOURCE
- PC SHELL
- PORTABLE
- MOUNTABLE ON A SAFETY HELMET
- ENERGY SAVING
- LITHIUM BATTERY
- LIGHT ANGLE ADJUSTMENT
- 2 PHASE BRIGHTNESS ADJUSTMENT
- RED SIGNAL FLASH
- LOW VOLTAGE WARNING INDICATOR

APPLICATIONS

- IDEAL FOR ANY POTENTIALLY FLAMMABLE AREAS SUCH AS PETROLEUM EXPLORATION SITES, CHEMICAL INDUSTRIAL PLANTS, AND MILITARY SITES.
- DANGEROUS PLACES:
 - ZONES - 0

TECHNICAL SPECIFICATIONS

- CHARGING VOLTAGE: AC100V- 240V 50HZ/60HZ
- 1X1W CREE LED LIGHT SOURCE
- LIFE: 100 000HRS
- BATTERY:
 - VOLTAGE 3.7
 - AH 1.4
 - CURRENT: PHASE 1 - 350 MA @ HIGH INTENSITY
 - CURRENT: PHASE 2 - 180 MA @ WORK LIGHT INTENSITY
 - CHARGE TIME 4-6HRS
 - RECYCLED 1000X
- CHARGER:
 - INPUT: AC100V-AC240V
- LIGHTING TIME:
 - PHASE 1 - 4HRS @ HIGH INTENSITY
 - PHASE 2 - 8HRS @ WORK LIGHT INTENSITY
- RANGE:
 - PHASE 1 - 2400LUX @ HIGH INTERCITY
 - PHASE 2 - 1200LUX @ WORK LIGHT INTENSITY
- LUMINOUS FLUX : 180LM
- DIMENSIONS: 50MM×65×60
- NET WEIGHT: 85 GRAMS

For More Detailed Information call us below in Singapore or Australia

STEPHEN R. PARKINSON, MARKETING DIRECTOR

Stealth Industries

28-D Pioneer Sector 2, #01-03 Mega Gas Industries Complex, Singapore, 628407.

Mobile: +6597406929, Tel: (+65) 68615545

Fax: (+65) 68616134

E-mail: steve@stealth.com.sg

sales@stealth.com.sg

LEX BOYLE, DIRECTOR

Arco Imports P/L

PO Box 409, Chatswood, NSW, 2067,

Australia.

Tel: +61438654765

E-mail: info@arcoimports.com



Explosion Proof LED Lighting



EMERGENCY LAMP

PN: EX5200

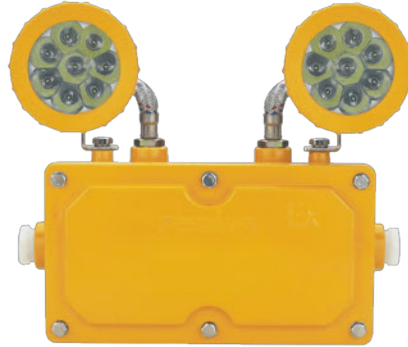

High Quality LED Lighting!

CERTIFICATION & APPROVALS

- IP65
- GB CODE: Ex D II C T6

FEATURES

- EXPLOSION PROOF DESIGN
- CORROSION RESISTANT
- WATER & DUST RESISTANT

APPLICATIONS:

- HARSH ENVIRONMENTS
 - INFLAMMABLE OR EXPLOSIVE PLACES
 - CHEMICAL INDUSTRY
 - EXPLORATION
 - MILITARY WORK PLACES
 - EMERGENCY LIGHTING WHEN POWER IS CUT OFF.
- DANGEROUS PLACES:
 - ZONES - 1, 2, 21, AND 22 HAZARDOUS PLACES
 - INFLAMMABLE & EXPLOSIVE GAS OR DUST ATMOSPHERES 11A, 11B, AND 11C

TECHNICAL SPECIFICATIONS

- CHARGING VOLTAGE:
 - AC100-V- 240V
 - 50HZ/60HZ
- LED LIGHT SOURCE
 - 2X2W LED
- LIFE: 50 000HRS
- POWER:
 - 220V WORKING
 - DC3.5V EMERGENCY
- EMERGENCY RUN TIME:
 - 36W/90MIN
- LUMINOUS FLUX :
 - 350LM
- ANTI CORROSION GRADE:
 - WF2
- INSULATION GRADE:
 - I
- CABLE DIAMETER:
 - Ø10- Ø14
- TEMPERATURE: -20°~40°C
- DIMENSIONS: 295X150X275MM
- NET WEIGHT: 3.4KG

For More Detailed Information call us below in Singapore or Australia

STEPHEN R. PARKINSON, MARKETING DIRECTOR

Stealth Industries

28-D Pioneer Sector 2, #01-03 Mega Gas Industries Complex, Singapore, 628407.

Mobile: +6597406929, Tel: (+65) 68615545

Fax: (+65) 68616134

E-mail: steve@stealth.com.sg

sales@stealth.com.sg

LEX BOYLE, DIRECTOR

Arco Imports P/L

PO Box 409, Chatswood, NSW, 2067, Australia.

Tel: +61438654765

E-mail: info@arcoimports.com



Explosion Proof Lighting



LED & FLUORESCENT TUBE LIGHT



PN: EX5400

High Quality Lighting!

PRODUCTS

SPECIFICATIONS & CERTIFICATION

- IIP23
- ANTI CORROSION GRADE: WF2
- INSULATION GRADE: II
- CABLE TYPE: TRIPLEX
- VOLTAGE: 220-250V

FEATURES

- EXPLOSION PROOF DESIGN
- LOW CARBON TUBE LAMP
- OPTIONAL EMERGENCY DEVICE
- 50% POWER SAVINGS OVER STANDARD FLUORESCENT LIGHTING
- TRAPEZIUM LIGHT OUTPUT SHAPE, COMBINES WITH RETURN AIR SYSTEM DESIGN, ACCORDING TO ADVANCED OPTICAL PRINCIPLES.

FEATURES A GENTLE AND EVEN LIGHT, WITH NO DAZZLE OR OVERSHADOW.

IT CAN EFFECTIVELY AVOID VISUAL FATIGUE CAUSED TO OPERATORS DURING ITS OPERATION.

- THE CASING USES A SPECIAL HIGH STRENGTH LIGHT ALLOY MATERIAL.
- THE SURFACE HAS BEEN SPRAYED TO ELIMINATE STATIC ELECTRICITY.
- EASY CONNECTIVITY AND EASY ACCESS

ITEM No.	LAMP TYPE	WATT	OUTPUT
EX5400 - Y1x14	T5 FLUORESCENT	1x14W	1456LM
BC5400 - Y1x28	T5 FLUORESCENT	1x28W	2912LM
EX5400 - Y2x14	T5 FLUORESCENT	2x14W	2912LM
EX5400 - Y2x28	T5 FLUORESCENT	2x28W	5824LM
EX5400-D-L 1x8	T8 LED	1x8W	880LM
EX5400-D-L 1x16	T8 LED	1x16W	1760LM
EX5400-S-L 2x8	T8 LED	2x8W	1760LM
EX5400-S-L 2x16	T8 LED	2x16W	3520LM
EX5400 - Y1x14J	T5 FLUORESCENT (EMERGENCY)	1x14W	1456LM
EX5400 - Y1x28J	T5 FLUORESCENT (EMERGENCY)	1x28W	2912LM
EX5400 - Y2x14J	T5 FLUORESCENT (EMERGENCY)	2x14W	2912LM
EX5400 - Y2x28J	T5 FLUORESCENT (EMERGENCY)	2x28	5824LM

For More Detailed Information call us below in Singapore or Australia

STEPHEN R. PARKINSON, MARKETING DIRECTOR

Stealth Industries

28-D Pioneer Sector 2, #01-03 Mega Gas Industries Complex, Singapore, 628407.

Mobile: +6597406929, Tel: (+65) 68615545

Fax: (+65) 68616134

E-mail: steve@stealth.com.sg

sales@stealth.com.sg

LEX BOYLE, DIRECTOR

Arco Imports P/L

PO Box 409, Chatswood, NSW, 2067,

Australia.

Tel: +61438654765

E-mail: info@arcoimports.com



Explosion Proof LED Lighting



MULTI-FUNCTION LED FLASHLIGHT

PN: EX7620



High Quality LED Lighting!



CERTIFICATION & APPROVALS

- IP66
- GB CODE: Ex IB T4
- STANDARD: GB3836.1-2000 GB3836.4-2000

FEATURES

- EXPLOSION PROOF DESIGN
- ADJUSTABLE FOCUS
- ADJUSTABLE HEAD: 0~130°
- FREQUENCY FLASH-OVER FUNCTION
- LONG DISTANCE COMMUNICATION RECOGNITION
- ENERGY SAVING
- LITHIUM BATTERY
- TWO MODE ADJUSTABLE LIGHT INTENSITY
- MAGNETIC BASE
- RAINPROOF AND FLOATATION ABILITY

APPLICATIONS

- IDEAL FOR ANY POTENTIALLY FLAMMABLE AREAS SUCH AS PETROLEUM EXPLORATION SITES, CHEMICAL INDUSTRIAL PLANTS, AND MILITARY SITES.
- DANGEROUS PLACES:
 - ZONES - 0

TECHNICAL SPECIFICATIONS

- CHARGING VOLTAGE: AC100-V- 240V 50HZ/60HZ
- 3W OR 1W LED LIGHT SOURCE
- LIFE: 100 000HRS
- BATTERY:
 - MAH 4000
 - VOLTAGE 3.7
 - CHARGE TIME 8HRS
 - RECYCLED 800x
- CHARGER:
 - INPUT: AC100V-AC240V
 - OUTPUT: DC4.5V
 - OUTPUT CURRENT: 1AMP
- LIGHTING TIME:
 - 3W - 7HRS @ HIGH INTENSITY
 - 1W - 14HRS @ HIGH INTENSITY
- RANGE:
 - 3W- 120MTRS
 - 1W - 70MTRS
- LUMINOUS FLUX : 180LM
- TEMPERATURE: -20°~40°C
- DIMENSIONS: 217.3MM×105.8×87
- NET WEIGHT: 370 GRAMS

For More Detailed Information call us below in Singapore or Australia

STEPHEN R. PARKINSON, MARKETING DIRECTOR

Stealth Industries

28-D Pioneer Sector 2, #01-03 Mega Gas Industries Complex, Singapore, 628407.

Mobile: +6597406929, Tel: (+65) 68615545

Fax: (+65) 68616134

E-mail: steve@stealth.com.sg

sales@stealth.com.sg

LEX BOYLE, DIRECTOR

Arco Imports P/L

PO Box 409, Chatswood, NSW, 2067, Australia.

Tel: +61438654765

E-mail: info@arcoimports.com



EXPLOSION PROOF FLOOD LIGHT

PN: EX9100



HIGH QUALITY LIGHTING!

SPECIFICATIONS

- GB CODE: EX DE II C T6/T4, DIP A20 T6/T4
- GB CERTIFICATE: NLE07374, NLE07375
- GRADE OF PROTECTION: IP65
- STANDARDS: GB3836.1-2000 GB3836.2-2000 GB3836.3-2000
- ANTI CORROSION GRADE: WF2
- POWER SUPPLY: 220V/50HZ
- SPACING HEIGHT RATIO: 2.6
- CABLE ENTRIES: G3/4"
- CABLE DIAMETER: Ø8 - Ø10
- DIMENSIONS: LAMP 440 x 266 x 170 MM
EXPLOSION PROOF BALLAST BOX 340 x 220 x 8 MM
- WEIGHT: LAMP 5KG
- EXPLOSION PROOF BALLAST BOX: 5.2KG

FEATURES

- EXPLOSION PROOF DESIGN
- OSRAM BRAND POWER SUPPLY AND APPLIANCES, WITH STABLE PERFORMANCE.
- TWIN EXPLOSION-PROOF CHAMBERS, WITH THE MAIN CHAMBER EXPLOSION-PROOF, AND THE CONNECTION CHAMBER SAFETY-ENHANCED.
- GOOD THERMAL RADIATION EFFECTS, EFFECTIVELY EXTENDING THE SERVICE LIFE OF LAMPS.
- STRONG RESISTANCE TO CORROSION, WATER AND DUST, APPLICABLE TO VARIOUS HARSH ENVIRONMENTS.

APPLICATION:

- EX9100 CAN BE USED IN ZONE 1 AND ZONE 2 HAZARDOUS AREAS.
- EX9120 CAN BE USED IN ZONE 21 AND ZONE 22 HAZARDOUS AREAS.

P/N	LAMP TYPE	WATT	LM	TEMP CLASS	HRS
EX9100-J70 EX9120-J70	MH	70W	5500	T6	10000
EX9100-J100 EX9120-J100	MH	100W	9000	T4	10000
EX9100-J150 EX9120-J150	MH	150W	13000	T4	10000
EX9100-N70 EX9120-N70	HPS	70W	6000	T6	28500
EX9100-N100 EX9120-N100	HPS	100W	9600	T4	28500
EX9100-N150 EX9120-N150	HPS	150W	16000	T4	28500

FOR MORE DETAILED INFORMATION CALL US BELOW IN SINGAPORE OR AUSTRALIA

STEPHEN R. PARKINSON, MARKETING DIRECTOR

STEALTH INDUSTRIES

28-D PIONEER SECTOR 2, #01-03 MEGA GAS INDUSTRIES COMPLEX, SINGAPORE, 628407.

MOBILE: +6597406929, TEL: (+65) 68615545

FAX: (+65) 68616134

E-MAIL: STEVE@STEALTH.COM.SG

LEX BOYLE, DIRECTOR

ARCO IMPORTS P/L

PO Box 409, CHATSWOOD, NSW, 2067, AUSTRALIA.

TEL: +61438654765

E-MAIL: INFO@ARCOIMPORTS.COM



EXPLOSION PROOF FLOOD LIGHT

PN: EX9150



HIGH QUALITY LIGHTING!

SPECIFICATIONS

- GB CODE: EX D IIB T3
- GRADE OF PROTECTION: IP65
- STANDARD: B3836.1-2000, B3836.2-2000
- ANTI CORROSION GRADE: WF2
- INSULATION GRADE: I
- POWER SUPPLY: 220V/50HZ
- CABLE DIAMETER: Ø10 - Ø14
- DIMENSION: LAMP 433 x 387 x 202 MM
EXPLOSION PROOF BALLAST BOX 288 x 203 x 125 MM
- WEIGHT: UNITY TYPE LAMP+ELECTRICAL BOX 16.1KG
LAMP LAMP 9KG
SPLIT TYPE ELECTRICAL BOX
EXPLOSION PROOF BALLAST BOX 6.8KG

FEATURES

- POWER FACTOR > 0.9
- ORANGE-FIGURED REFLECTION PANEL MAKES THE LIGHT GENTLE AND LUMINANCE ANGLE LARGE.
- STRONG RESISTANCE TO CORROSION, WATER AND DUST, APPLICABLE TO VARIOUS HARSH ENVIRONMENTS.
- LATERAL COVER IS MOUNTED ON THE LAMP, ENABLING EASY CHANGE OF BULBS.
- THE LAMP CAN BE MOUNTED EITHER IN PEDESTAL OR ON WALL, ADJUSTABLE WITHIN THE ANGLES OF 45~90°.

APPLICATION:

THIS PRODUCT IS APPLICABLE TO LARGE AREA FLOOD LIGHTING IN VARIOUS EXPLOSIVE AND FLAMMABLE PLACES, OUTDOOR OPERATION OR CONSTRUCTION SITES, AS WELL AS PLACES WITH DEVICES AND FACILITIES.

1: DANGEROUS PLACES IN ZONE 2

2: IIB EXPLOSIVE GAS ENVIRONMENT OR FLAMMABLE ENVIRONMENT.

P/N	LAMP TYPE	WATT	LM	WGT	TEMP CLASS	Hrs
EX9130-J250	MH	250W	25000	17KG	T4	10000
EX9130-J400	MH	400W	36000	19KG	T3	10000
EX9130-N250	HPS	250W	27500	17KG	T4	28500
EX9130-N400	HPS	400W	50000	19KG	T3	28500

FOR MORE DETAILED INFORMATION CALL US BELOW IN SINGAPORE OR AUSTRALIA

STEPHEN R. PARKINSON, MARKETING DIRECTOR

STEALTH INDUSTRIES

28-D PIONEER SECTOR 2, #01-03 MEGA GAS INDUSTRIES COMPLEX, SINGAPORE, 628407.

MOBILE: +6597406929, TEL: (+65) 68615545

FAX: (+65) 68616134

E-MAIL: STEVE@STEALTH.COM.SG

LEX BOYLE, DIRECTOR

ARCO IMPORTS P/L

PO Box 409, CHATSWOOD, NSW, 2067, AUSTRALIA.

TEL: +61438654765

E-MAIL: INFO@ARCOIMPORTS.COM



EXPLOSION PROOF LIGHT

PN: EX9200



HIGH QUALITY LIGHTING!

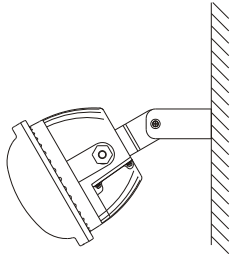

Wall mounting(rotating 90° form up to down)B1

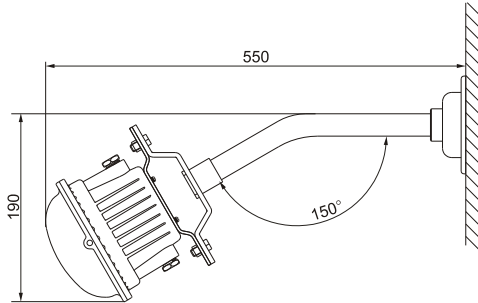

30° wall mounting(B2)

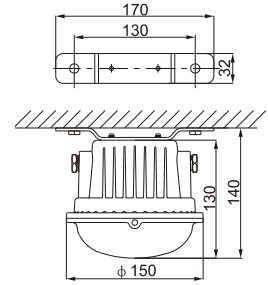

Roof mounting(X)

SPECIFICATIONS

- GB CODE: EX DE II C T6
- GB CERTIFICATE: NLE09441
- GRADE OF PROTECTION: IP65
- STANDARD: GB3836.1-2000, GB3836.2-2000 GB3836.3-2000

FEATURES:

- CREE BRAND WHITE LED LIGHT SOURCE.
- 50,000 HOURS. IT IS ALSO MAINTENANCE-FREE.
- WIDE VOLTAGE DESIGN.
- LED ANTI-DAZZLE LENS, IT WILL NOT CAUSE WEARINESS FOR THE OPERATORS' EYES.
- STRONG RESISTANCE TO CORROSION, WATER AND DUST, APPLICABLE TO VARIOUS HARSH ENVIRONMENTS.
- IT CAN BE MOUNTED ON A ROOF OR WALL.
- IT IS PROVIDED WITH DUAL EXPLOSION-PROOF INTERFACES AND CAN BE CONNECTED IN SERIES.

APPLICATION:

- EXPLOSIVE AND FLAMMABLE PLACES FOR OIL, CHEMICAL, SHIP-MAKING AND METALLURGY, ETC.
- DANGEROUS PLACES IN ZONE 1, ZONE 2 OR ZONE 20, ZONE 21, ZONE 22;
- GRADE IIA AND IIB EXPLOSIVE GAS ENVIRONMENT OR FLAMMABLE DUST ENVIRONMENT.

ITEM	UNIT	EX9200A	EX9200B	EX9200C
VOLTAGE	AC/DC	220V	24V	36V
WATTAGE	W	4x3W	2x3W	2x1.5W
LUMEN	LM	560	280	200
LIFE	HRS	100,000	100,000	100,000
ANTI CORROSION GRADE		WF2		
INSULATION GRADE		I		
SPACING HEAIGHT RATIO		1.2		
CABLE DIAMETER	MM	Ø6~Ø8	Ø6~Ø8	Ø6~Ø8
DIMENTION	MM	147×140	147×140	147×140
WEIGHT	KG	1.3	1.3	1.3



EXPLOSION PROOF PLATFORM LIGHT

PN: EX9300



HIGH QUALITY LIGHTING!

CERTIFICATION & APPROVALS

- GB CODE: ELECTRODELESS - EXD CT6 - DIP A20 TA□T6,
- GB CODE: MH & HPS - EXD CT4 - DIP A20 TA□TT4
- GB CERTIFICATE; CNEx09.0190
- GRADE OF PROTECTION: IP65
- STANDARD; GB3836.1-2000, GB3836.2-2000

FEATURES: ELECTRODE-LESS (EL)

- IT ADOPTS AN ELECTRODE-LESS LIGHT SOURCE, WITH THE SERVICE LIFE AS LONG AS 60,000 HOURS.
- IT USES A DUAL CHAMBER EXPLOSION-PROOF DESIGN, MAKING IT SAFER IN EXPLOSIVE AND FLAMMABLE PLACES.
- IT CAN BE OPERATED NORMALLY UNDER WIDE A VOLTAGE RANGE. ITS BULB LIGHTNESS WILL NOT BE AFFECTED BY THE VOLTAGE VARIATION WITHOUT FLASHOVER, AND IT CAN BE STARTED AND RESTARTED INSTANTLY.
- STRONG RESISTANCE TO CORROSION, WATER AND DUST, APPLICABLE TO VARIOUS HARSH ENVIRONMENTS.
- IT HAS TWO CABLE OUTLETS AND CAN BE CONNECTED WITH THE POWER SUPPLY IN SERIES.

FEATURES: METAL HALIDE (MH)
& HIGH PRESSURE SODIUM (HPS)

- OSRAM BRAND POWER SUPPLY AND APPLIANCES, WITH STABLE PERFORMANCE.
- IT USES A DUAL-CHAMBER EXPLOSION-PROOF DESIGN, MAKING IT SAFER IN EXPLOSIVE AND FLAMMABLE PLACES.
- STRONG RESISTANCE TO CORROSION, WATER AND DUST, APPLICABLE TO VARIOUS HARSH ENVIRONMENTS.
- IT HAS TWO CABLE OUTLETS AND CAN BE CONNECTED WITH THE POWER SUPPLY IN SERIES.

APPLICATION:

- THIS PRODUCT IS APPLICABLE TO FIXED LIGHTING IN EXPLOSIVE AND FLAMMABLE PLACES, SUCH AS THE PETROCHEMICAL, OIL PLATFORMS, OIL STATIONS, OIL PUMP STATIONS, OIL TRANSMISSION STATION, ETC.
- DANGEROUS PLACES IN ZONE 1, ZONE 2 OR ZONE 20, ZONE 21, ZONE 22;
- GRADE IIA OR IIB EXPLOSIVE GAS ENVIRONMENT OR FLAMMABLE DUST ENVIRONMENT.

SPECIFICATIONS:

- POWER SUPPLY : AC 220V / 50HZ
- INGRESS PROTECTION: IP65
- ANTICORROSION GRADE : WF2
- INSULATION GRADE: I
- SPACING HEIGHT RATIO: 2.5
- CABLE DIAMETER: Ø8 - Ø10
- DIMENSION: LAMP - 200 x 315MM
EXPLOSION PROOF BALLAST BOX 340 x 220 x 88 MM
- WEIGHT: LAMP 5.2KG
EXPLOSION PROOF BALLAST BOX 4.8KG

ITEM	LIGHT SOURCE	WATT	LUMEN	TEMP CLASS	LIFE (HRS)
EX9300-W50	EL	50	4000	T6	60,000
EX9300-W85	EL	85	6800	T4	60,000
EX9300-J70	MH	70	5500	T6	10,000
EX9300-J100	MH	100	9000	T4	10,000
EX9300-J150	MH	150	13000	T4	10,000
EX9300-N70	HPS	70	6000	T6	28,500
EX9300-N100	HPS	100	9600	T4	28,500
EX9300-N150	HPS	150	16000	T4	28,500



EXPLOSION PROOF PLATFORM LIGHT

PN: EX9330



HIGH QUALITY LIGHTING!

CERTIFICATION & APPROVALS

- GB CODE: EXD IIC T4/T3, DIP A20 TA□T4/T3
- INGRESS GRADE: IP65
- STANDARD; GB3836.1-2000, GB3836.2-2000
- ANTICORROSION GRADE: WF2

FEATURES: ELECTRODE-LESS (EL)

- IT ADOPTS AN ELECTRODE-LESS LIGHT SOURCE, WITH THE SERVICE LIFE AS LONG AS 60,000 HOURS.
- IT USES A DUAL CHAMBER EXPLOSION-PROOF DESIGN, MAKING IT SAFER IN EXPLOSIVE AND FLAMMABLE PLACES.
- IT CAN BE OPERATED NORMALLY UNDER A WIDE VOLTAGE RANGE. ITS BULB LIGHTNESS WILL NOT BE AFFECTED BY THE VOLTAGE VARIATION WITHOUT FLASHOVER, AND IT CAN BE STARTED AND RESTARTED INSTANTLY.
- STRONG RESISTANCE TO CORROSION, WATER AND DUST, APPLICABLE TO VARIOUS HARSH ENVIRONMENTS.
- IT HAS TWO CABLE OUTLETS AND CAN BE CONNECTED WITH THE POWER SUPPLY IN SERIES.

FEATURES: METAL HALIDE (MH) & HIGH PRESSURE SODIUM (HPS)

- HIGH QUALITY AND RELIABLE LIGHT SOURCE.
- LIGHT ALUMINIUM ALLOY SHELL WITH ELECTROSTATIC SPRAYING, WEAR RESISTANT, WATER PROOF, DUST PROOF, AND ANTI-CORROSION MAKES THE LAMP ABLE TO BE USED IN HAZARDOUS ENVIRONMENT
- LAMP BASE AND LAMP ARE CONNECTED WITH A SCREW THREADED MOUNTING TYPE JOINT□WHICH MAKES THE MOUNTING AND REPAIRING EASY

APPLICATION:

- IDEAL FOR ANY POTENTIALLY INFLAMMABLE AND EXPLOSIVE PLACES LIKE PETROLEUM PLATFORM, GAS STATION, OIL PUMP ROOM, TRANSSHIPMENT STATION, ETC. ,AS A FIXED LIGHTING DEVICE.
- DANGEROUS PLACES IN ZONE 1, ZONE 2, ZONE 21, AND ZONE 22;
- GRADE IIA,IIBOR IIC EXPLOSIVE GAS ENVIRONMENT OR FLAMMABLE DUST ENVIRONMENT;
- DANGEROUS DUST ATMOSPHERE IN ZONE 20, ZONE 21 OR ZONE 22.

SPECIFICATIONS:

- RATED VOLTAGE□AC220V/50HZ
- LIGHT SOURCE□EL, MH, HPS -150W□250W□400W
- CABLE DIAMETER □ 10MM- 14MM
- PROTECTING HOOD □OPTIONAL ACCESSORY□
- DIAMETER□ 367×630MM
- WEIGHT: LAMP 5.2KG
EXPLOSION PROOF BALLAST BOX 4.8KG

ITEM	LIGHT SOURCE	WATT	LUMEN	TEMP CLASS	LIFE (HRS)
EX9330-W135	EL	150	10800		60,000
EX9330-W165	EL	165	13200		60,000
EX9330-W200	EL	200	16000		60,000
EX9330-J150	MH	150	13000	T4	10,000
EX9330-J250	MH	250	25000	T4	10,000
EX9330-J400	MH	400	36000	T3	10,000
EX9330-N150	HPS	150	16000	T4	28,500
EX9330-N250	HPS	250	27500	T4	28,500
EX9330-N400	HPS	400	40000	T3	28,500



EXPLOSION PROOF LED TUNNEL LIGHT

PN: EXDGS

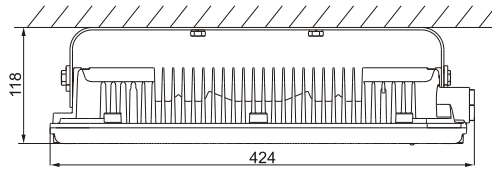

Ceiling mounting(D)

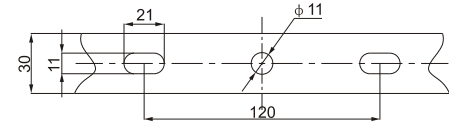

Mounting hole



HIGH QUALITY LED LIGHTING!

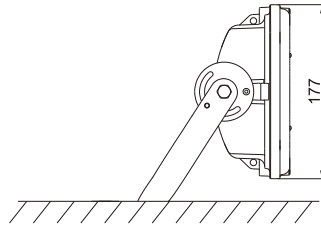

Pedestal mounting(Z1)

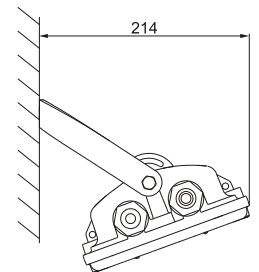

Pedestal mounting(Z2)

CERTIFICATION & APPROVALS

- CSST Ex CERTIFICATION CERTIFICATE 21020445
- SAFETY SIGN No. MAH100093, MAH100093
- GB CODE EX D I
- GRADE OF PROTECTION IP66
- STANDARD GB3836.1-2000, GB3836.2-2000 MT221-2005

FEATURES:

- WHITE CREE LED LIGHT SOURCE. THE LAMP HAS VERY EXCELLENT HEAT RADIATION EFFECTS, WHICH HAS EFFECTIVELY SOLVED THE PROBLEM OF LED LIGHT DEGRADATION DUE TO HIGH TEMPERATURES.
- IT ILLUMINATES IN TWO WAYS, WITH EVEN LIGHTING AND A LONGER DISTANCE. IT IS ESPECIALLY SUITABLE FOR TUNNELS. WHEN THE LAMP IS HUNG 3M HIGH, THE LIGHTING DISTANCE CAN REACH 15M AND ITS EVEN LIGHTING DISTRIBUTION COMES TO 0.7.
- STRONG RESISTANCE TO CORROSION, WATER AND DUST, APPLICABLE TO VARIOUS HARSH ENVIRONMENTS.
- IT IS PROVIDED WITH TWO CONNECTORS AND CAN BE CONNECTED IN SERIES.

APPLICATION:

- THIS PRODUCT IS MAINLY USED IN DANGEROUS EXPLOSIVE PLACES WITH GAS, SUCH AS A COAL MINE.
- IT IS ALSO APPLICABLE TO COAL MINING TUNNELS, COAL MINE CONSTRUCTION TUNNELS, AND COAL CHAMBERS WITH LARGE RAINFALL.
- AMBIENT TEMPERATURE: -20 +40

SPECIFICATIONS:

- RATED VOLTAGE AC127V
- WATTAGE 10W/20W
- CABLE DIAMETER 10MM- 14MM
- PROTECTING HOOD OPTIONAL ACCESSORY
- DIMENSIONS 427×127×77MM
- WEIGHT: 4.1KG

ITEM	LIGHT SOURCE	WATT	LUMEN	LIFE (HRS)
EXDGS10-127L(A)	LED	10	1150	100,000
EXDGS24-127L(A)	LED	24	1185	100,000



Explosion Proof LED Marker Light



CERTIFICATION & APPROVALS

- IP65
- GB CODE: Ex D II C T6
- ANTI-CORROSION GRADE: WF2

FEATURES

- EXPLOSION PROOF DESIGN
- AUTOMATIC EMERGENCY FUNCTION
 - 3 HOURS OF BACK-UP LIGHT
- ENERGY SAVING
- MAINTENANCE FREE
- FIELD EFFECTIVE LUMINESCENT CRYSTAL TECHNIQS
 - 10 000HRS
- INSTALLATION
 - WALL MOUNTABLE TYPE
 - CEILING MOUNTABLE TYPE

APPLICATIONS

- IDEAL FOR ANY POTENTIALLY FLAMMABLE AREAS SUCH AS PETROLEUM EXPLORATION SITES, CHEMICAL INDUSTRIAL PLANTS, AND MILITARY SITES.
- DANGEROUS PLACES:
 - ZONES - 1, 2, 21, & 22
- GRADE IIA, IIBOR, IIC EXPLOSIVE GAS ENVIRONMENTS OR FLAMMABLE DUST ENVIRONMENTS
- DANGEROUS DUST ATMOSPHERE IN ZONE 20,ZONE 21,OR ZONE 22.
- AMBIENT TEMPERATURE ZONES

TECHNICAL SPECIFICATIONS

- AC 220 V
- 1W LED LIGHT SOURCE
- CABLE DIAMETER
 - Ø10MM - Ø14MM
- LAMP DIAMETER
 - 270 x 324 x 80
- WEIGHT: 3.4KG
- LUMINOUS FLUX : 80LM

LED MARKER LAMP



Explosion Proof!

PN: EP-ML

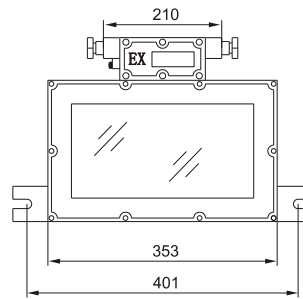

Wall mounting(B)

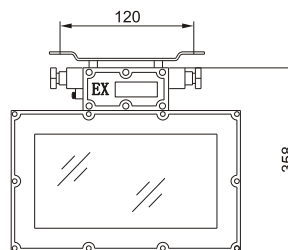
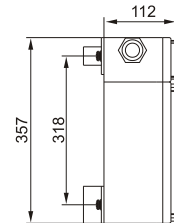

Roof mounting(X)

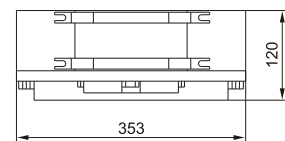

For More Detailed Information call us below in Singapore or Australia

STEPHEN R. PARKINSON, MARKETING DIRECTOR

Stealth Industries

28-D Pioneer Sector 2, #01-03 Mega Gas Industries Complex, Singapore, 628407.

Mobile: +6597406929, Tel: (+65) 68615545

Fax: (+65) 68616134

E-mail: steve@stealth.com.sg

sales@stealth.com.sg

LEX BOYLE, DIRECTOR

Arco Imports P/L

PO Box 409, Chatswood, NSW, 2067, Australia.

Tel: +61438654765

E-mail: info@arcoimports.com